



BALL LIGHT  
SMALL WALL BRACKET PENDANT ROD, 2008

Polished Brass.  
Pendant rod length to order.



OVERALL DIMENSIONS

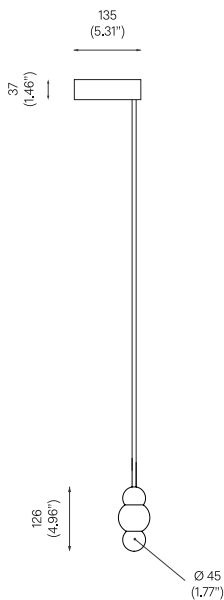

BACKPLATE DIMENSIONS

Mounting screws not included.  
6mm countersunk screw recommended.

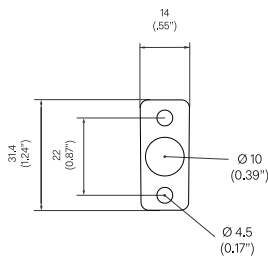

STANDARD MATERIAL/FINISH



MA-BLL-WBF-PBR  
Polished Brass

CUSTOM FINISHES



Plated Nickel



Plated Copper



Custom Patina

BULB SPECIFICATIONS

Input voltage: 120V / 240V  
Maximum wattage: 5W  
120V / 240V dimmable LED triac  
Product weight: 2kg  
IP20

Please supply required drop length of fixture,  
measured from the top to the bottom of the  
fitting at time of order.

Minimum total drop 180mm.  
Maximum total drop 2100mm.

Please allow 25mm tolerance of drop length.

120V version supplied with paintable junction  
box cover.

CLEANING INSTRUCTIONS

Before cleaning, lighting fixtures must  
be turned off and unplugged from mains  
electricity. Whilst cleaning please take care  
and use the gloves provided.

Polished Brass: As the item is unlacquered  
it will naturally oxidise and darken. Upon  
touching the items without gloves, fingerprints  
are likely to occur and leave marks. Use  
a good quality brass cleaning liquid and  
follow the product instructions using the  
extra soft dust cloth. Do not apply pressure  
on persistent marks. Remove them using  
repeated gentle motions and by reapplying  
the brass cleaning liquid.

Plated Finish: Use a lightly damp soft dust  
cloth and gently go over marks until clean.  
Dry it afterwards with a soft dust cloth.

Patinated Finish: Use a dry soft dust cloth  
and gently go over marks until clean. The  
brass patina is achieved through an artisanal  
technique of applying pigments by hand  
during a hot patination process. Through this  
alchemic process, the brass is transformed  
whilst retaining the material's inherent  
qualities. It will mature and change overtime.  
The manner and speed in which it will change  
will depend on the environment, handling  
and the level and frequency of maintenance.  
Verdigris can also appear when the copper in  
the brass begins to oxidise.

Opaline Glass: Remove the opaline glass from  
the product. Using a lightly damp cloth, clean  
only the outside of the sphere. Only put the  
glass sphere back on the product once it is  
fully dry.



BALL LIGHT  
LARGE WALL BRACKET PENDANT ROD, 2008

Polished Brass.  
Pendant rod length to order.



OVERALL DIMENSIONS

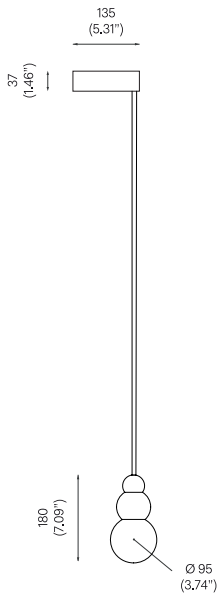

BACKPLATE DIMENSIONS

Mounting screws not included.  
6mm countersunk screw recommended.

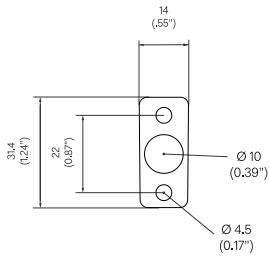

STANDARD MATERIAL/FINISH



MA-BLL-WBF-PBR  
Polished Brass

CUSTOM FINISHES

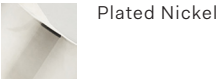

Plated Nickel

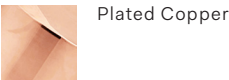

Plated Copper

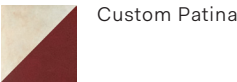

Custom Patina

BULB SPECIFICATIONS

Input voltage: 120V / 240V  
Maximum wattage: 20W  
120V / 240V dimmable LED triac  
Product weight: 3kg  
IP20

Please supply required drop length of fixture,  
measured from the top to the bottom of the  
fitting at time of order.

Minimum total drop 220mm  
Maximum total drop 2135mm

Please allow 25mm tolerance of drop length.

120V version supplied with paintable junction  
box cover.

CLEANING INSTRUCTIONS

Before cleaning, lighting fixtures must  
be turned off and unplugged from mains  
electricity. Whilst cleaning please take care  
and use the gloves provided.

Polished Brass: As the item is unlacquered  
it will naturally oxidise and darken. Upon  
touching the items without gloves, fingerprints  
are likely to occur and leave marks. Use  
a good quality brass cleaning liquid and  
follow the product instructions using the  
extra soft dust cloth. Do not apply pressure  
on persistent marks. Remove them using  
repeated gentle motions and by reapplying  
the brass cleaning liquid.

Plated Finish: Use a lightly damp soft dust  
cloth and gently go over marks until clean.  
Dry it afterwards with a soft dust cloth.

Patinated Finish: Use a dry soft dust cloth  
and gently go over marks until clean. The  
brass patina is achieved through an artisanal  
technique of applying pigments by hand  
during a hot patination process. Through this  
alchemic process, the brass is transformed  
whilst retaining the material's inherent  
qualities. It will mature and change overtime.  
The manner and speed in which it will change  
will depend on the environment, handling  
and the level and frequency of maintenance.  
Verdigris can also appear when the copper in  
the brass begins to oxidise.

Opaline Glass: Remove the opaline glass from  
the product. Using a lightly damp cloth, clean  
only the outside of the sphere. Only put the  
glass sphere back on the product once it is  
fully dry.